

HIAB XS 077 Range 6-8 tm

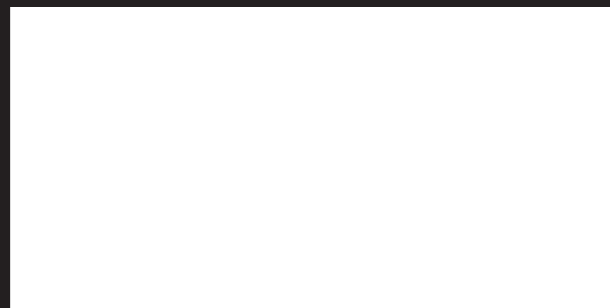

Product brochure



The HIAB XS 077 is performance at it's best

The flexibility of the XS manufacturing technique, gives you the HIAB XS 077, offering the complete crane solution. For versatile, efficient and reliable performance, no other crane in the 7 tonne metre class comes close. Hiab gives you more functionality, higher standards of safety and greater productivity than ever before. The crane can be delivered with the CL, Duo or HiDuo control system.

State of the art **versatility**

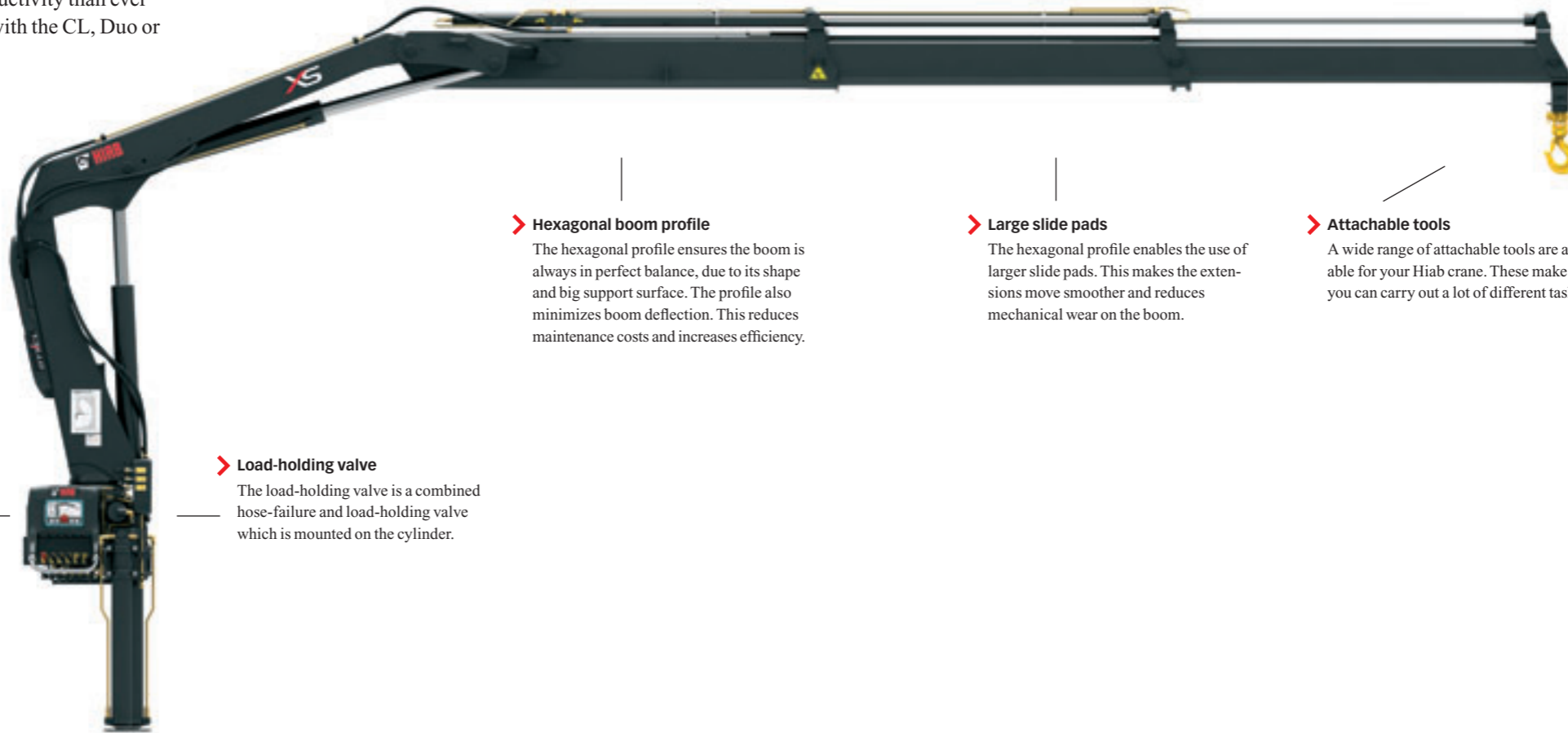

> **Column close to centre**

The outreach of the crane is almost the same on both sides of the truck. This is particularly important for cranes in the medium range, where the outreach is often a critical factor. The weight of the crane is better distributed across the chassis which also makes the design of the auxiliary frame simpler.

> **Load-holding valve**

The load-holding valve is a combined hose-failure and load-holding valve which is mounted on the cylinder.

> **Hexagonal boom profile**

The hexagonal profile ensures the boom is always in perfect balance, due to its shape and big support surface. The profile also minimizes boom deflection. This reduces maintenance costs and increases efficiency.

> **Large slide pads**

The hexagonal profile enables the use of larger slide pads. This makes the extensions move smoother and reduces mechanical wear on the boom.

> **Attachable tools**

A wide range of attachable tools are available for your Hiab crane. These make sure you can carry out a lot of different tasks.

> **Duo control system**

The Duo crane gives you all the benefits of the CL model, plus an extra boost of capacity. The control system also features a function called Automatic Duty Control (ADC), which senses the job being done. A Duo crane is equal in weight to the corresponding CL model, offering you an improved weight-capacity ratio.

> **SPACE 3000 intelligence system**

The SPACE 3000 is the basic electronic system for intelligently monitoring and controlling the electronic functions. These functions are focused on assisting the operator in two aspects, safety and productivity.

Safety is managed by an Overload Protection (OLP) function and productivity is increased by the Automatic Duty Control (ADC) function.

Further more, the system handles functions primarily used by service personnel such as fault code indication and load cycle data. Equipped with these functions the SPACE 3000 is a part of the Duo control system.

> **Mechanics for improved efficiency**

The crane has an optional E-link solution which gives excellent lifting capabilities when working with a fully stretched boom system, useful when scaffolding. You can also order the crane with an optional short second boom. This S-boom system increases lifting height close to the column, proving very useful when for example loading a second-layer pallet close to the column.

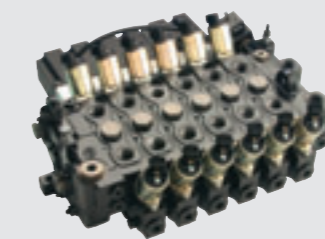

< **Valve 80**

The HIAB Valve 80 is a top of the line open centre valve based on well proven technique which gives superb reliability. The valve handles large oil flows and provides great precision and ease of operation.

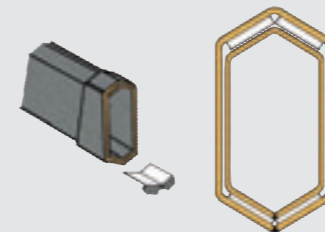

< **Hexagonal boom profile**

The hexagonal profile used on Hiab booms is a ground-breaking design introduced by Hiab many years ago. It is now standard throughout the market of loader cranes. Even the smallest of Hiab cranes benefit from this design.

< **Control panel**

The levers are positioned at the crane base. Cross-controls give the same sequence of levers on both sides. As an option the levers can be positioned at a control platform or high seat.